

Site Layout Plan for Fosterstown North as permitted under ABP Ref.: 308366-20  
 Indicative Landscape Masterplan for Fosterstown North, as submitted with ABP Ref.: 308366-20

SPINE ROAD  
 NORTHERN LANDS  
 MASTERPLAN

EXISTING CENTRAL TREELINE  
 PUBLIC OPEN SPACE  
 NORTHERN LANDS  
 MASTERPLAN

SHARED PEDESTRIAN/CYCLE ROUTE  
 NORTHERN LANDS  
 MASTERPLAN

RIPARIAN STRIP  
 NORTHERN LANDS  
 MASTERPLAN

FUTURE SCHOOL SITE  
 NORTHERN LANDS  
 MASTERPLAN

NOTE  
 \* Future pedestrian access to adjoining lands,  
 refer to engineering drawings for details'

Gaybrook stream

retained vegetation

NOTE  
 \* Future access to adjoining lands,  
 refer to engineering drawings for details'

NOTE  
 \* Potential for future connections to be facilitated by the Planning Authority'

NOTE  
 \* Potential for future pedestrian/cycle connections to be facilitated by the Planning Authority'

NOTE  
 \* Potential for future pedestrian/cycle connections to be facilitated by the Planning Authority'

NOTE  
 \* Potential for future pedestrian/cycle connections to be facilitated by the Planning Authority'

NOTE  
 \* Potential for future pedestrian/cycle connections to be facilitated by the Planning Authority'

NOTE  
 \* Potential for future pedestrian/cycle connections to be facilitated by the Planning Authority'

NOTE  
 \* Potential for future pedestrian/cycle connections to be facilitated by the Planning Authority'

NOTE  
 \* Potential for future pedestrian/cycle connections to be facilitated by the Planning Authority'

NOTE  
 \* Potential for future pedestrian/cycle connections to be facilitated by the Planning Authority'

NOTE  
 \* Potential for future pedestrian/cycle connections to be facilitated by the Planning Authority'

NOTE  
 \* Potential for future pedestrian/cycle connections to be facilitated by the Planning Authority'

NOTE  
 \* Potential for future pedestrian/cycle connections to be facilitated by the Planning Authority'

NOTE  
 \* Potential for future pedestrian/cycle connections to be facilitated by the Planning Authority'

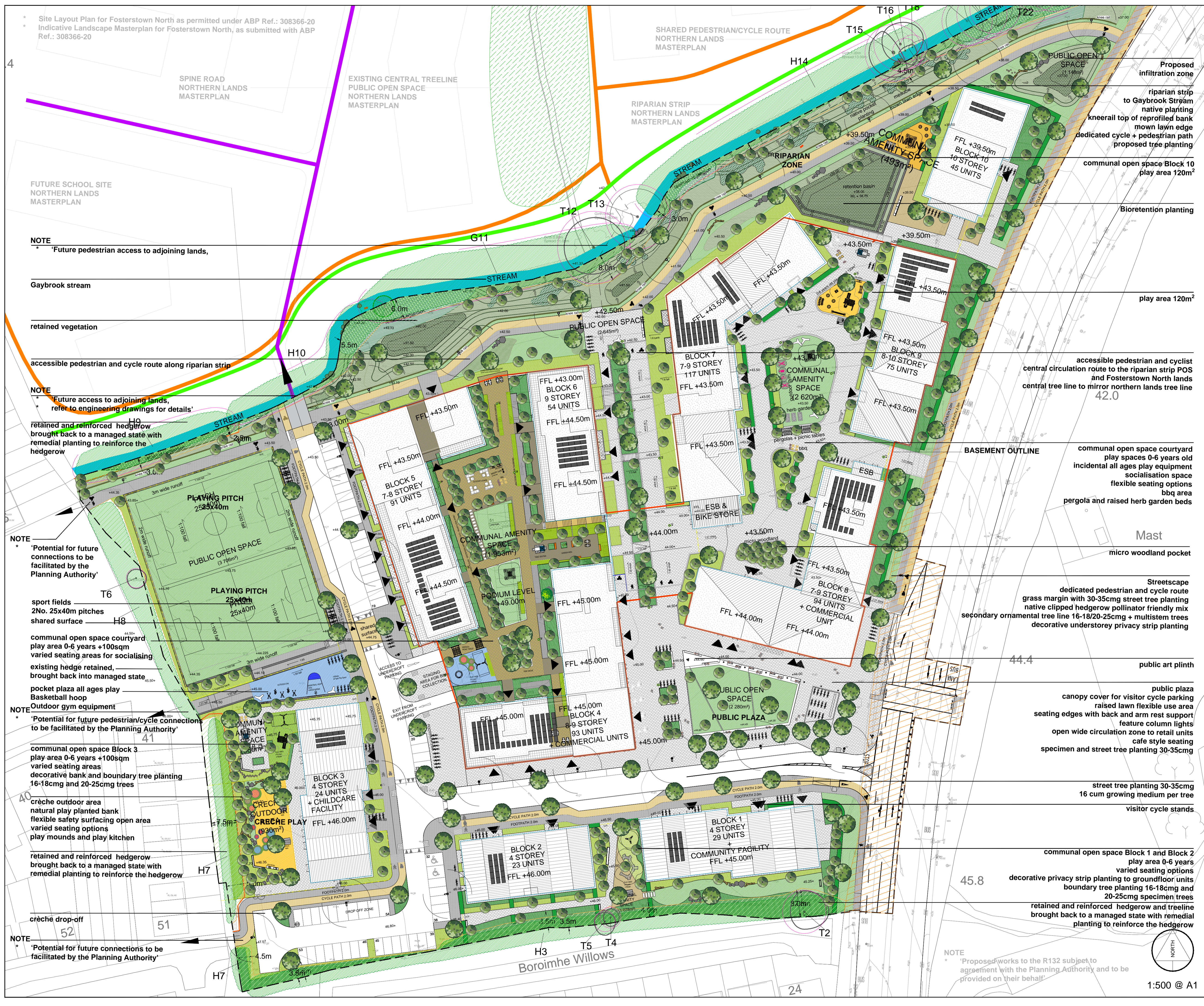

**KEY**

- In situ Concrete Footpath refer to Engineers Documentation
- Buff Coloured Tactile Paving Pedestrian Crossing refer to Engineers Documentation
- Coloured Macadam to shared surfaces and cycle paths refer to Engineers Documentation
- Road Buildup refer to Engineers Documentation
- High Quality Stone Aggregate PCC Terrace Paving Flag 50mm pedestrian 80mm deep shared surface areas
- Compacted Gravel Ballylusk Surface
- Wetpour Safety Surfacing Play Areas
- Reinforced Grass Play Safety Surface 200mm sand/soil depth on subbase
- Decorative Shrub Planting 75% pollinator friendly mix 450mm topsoil depth
- Woodland Shrub Block Planting and Woodland Understorey 450mm topsoil depth
- Grass seeding 300mm topsoil depth
- Green Roof Pollinator friendly sedum matting 150mm topsoil depth
- Meadow + Pollinator friendly mowing regime 150mm topsoil depth
- Existing Hedgerow/Tree Retained and Protected refer to Arborist Documentation
- New Tree 5m dia 20-25cmg (specimen 30-35cmg)
- Small New Tree 3m dia 16-18cmg or multistem +3.5m height
- Hedge Planting 600mm topsoil depth
- Seating and Picnic Table Hardwood
- Seat with back and armrests Hardwood
- Lounge Social Seating
- Pergola
- 347No. Visitor Cycle Parking Sheffield stand Grade 316 stainless steel
- Ventilation Grille
- Light Column refer to M+E Engineer documentation

**MITCHELL + ASSOCIATES**  
 LANDSCAPE ARCHITECTURE URBAN DESIGN

PROJECT: Fosterstown North SHD  
 CLIENT: J. Murphy (Developments) Limited  
 JOB NO: LFOS004  
 DRAWING: Landscape Masterplan  
 DRAWING NO: 100

DRAWN BY: Celia Harris	CHECKED: CH	DATE: 14 03 2022
STATUS: Planning Submission	SCALE: 1:500 @ A1	REVISION: 00

NOTES:  
 All dimensions are in millimeters unless otherwise stated and shall be checked and confirmed by the contractor on site. Any discrepancies shall be immediately reported to the landscape architects. Work to figured dimensions only - Do not scale from drawing. Do Not Scale. Use Figured Dimensions Only. Not for Construction Purpose unless Specifically Marked.  
 © THIS DRAWING IS COPYRIGHT OF MITCHELL + ASSOCIATES

1:500 @ A1